

Inner 2-Way Tray-A1 Installation Procedure

Install the Inner 2-Way Tray-A1 to its host machine as instructed in this booklet.

- For installation, you will need a Philips screwdriver (about 150 mm or shorter).
- If a Saddle Finisher-G1 is to be installed at the same time, install the Inner 2-Way Tray-A1 first.

1. Unpacking

Unpack the shipping box of the tray, and check to make sure that none of the following is missing:

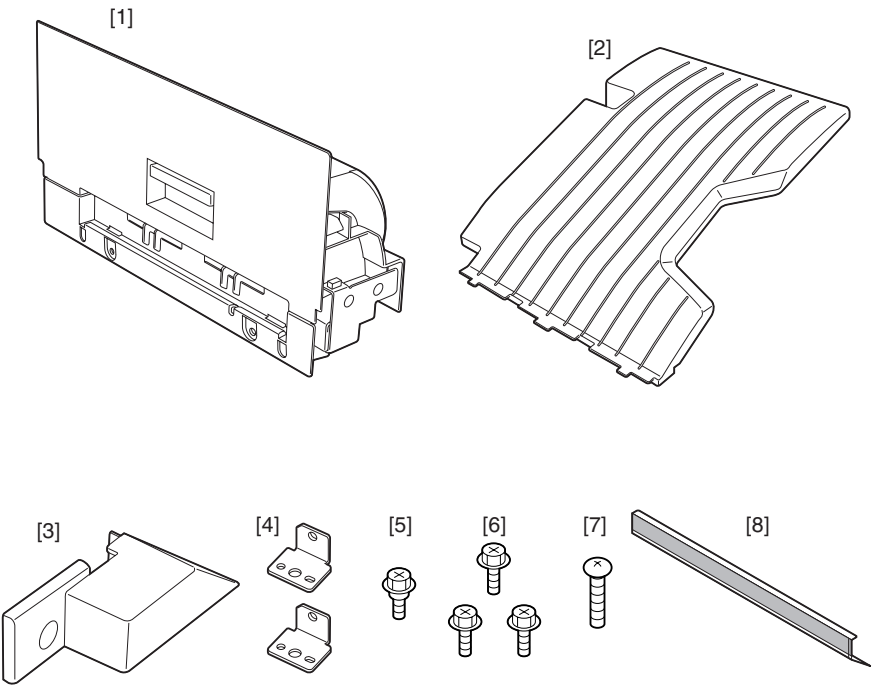

F1-1

[1] Inner 2-way tray delivery unit.....	1 unit	[5] Stepped screw	1 pc.
[2] Inside delivery tray.....	1 pc.	[6] Screw (M4×8)	3 pc.
[3] Connector cover	1 pc.	[7] Screw (M4×14)	1 pc.
[4] Mounting plate	2 pc.	[8] Protective sheet	1 pc.

2. Installation

- 1) Remove the left cover [1] of the host machine.
(The mounting screw and the stepped screw will be used later.)

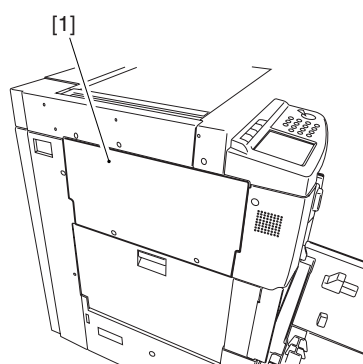

F2-1

- 2) Remove the right inside cover [2] of the host machine.
Remove the right column cover [1] once, and remove the right inside cover; then, mount back the right column cover.

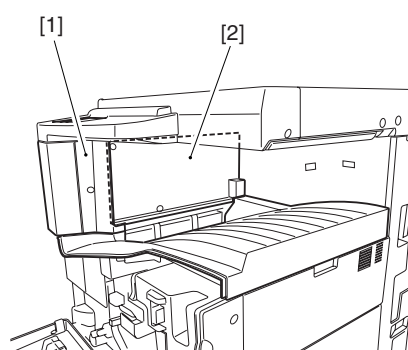

F2-2

- 3) Mount the two tray mounting plates [1] to the stay of the host machine with the screw (M4×8) [2] that comes with the tray (1 screw each).

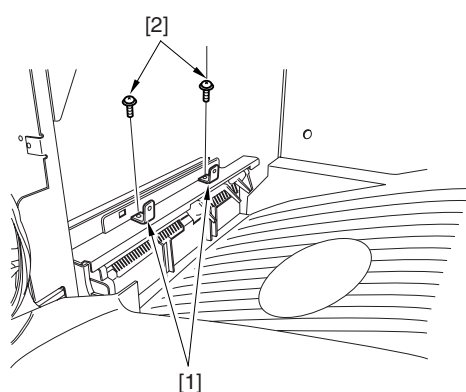

F2-3

- 4) Attach the protective sheet [1] to the stay of the host machine. At this time, be sure to match the right edge [2] on the sheet with that of the bend of the stay.

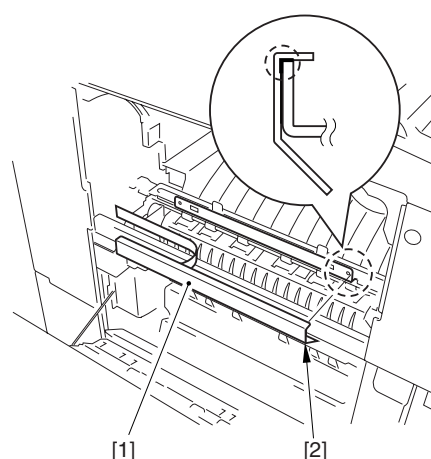

F2-4

- 5) Fit the inner 2-way delivery unit [1] in the host machine. Place the rib area [2] of the tray on the stay [2] of the host machine; then, move the unit in the direction of the arrow in the following figure.

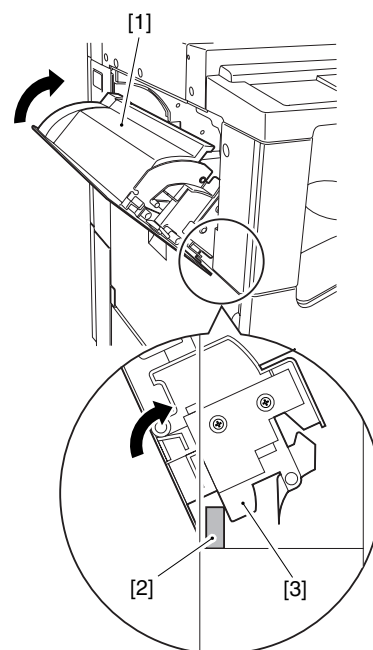

F2-5

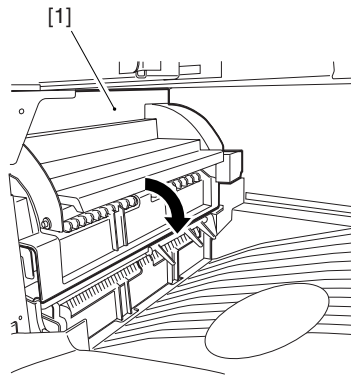
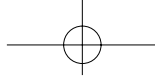

F2-6

- 6) Secure the inner 2-way delivery unit [1] with two screws [2] and two stepped screws [3]. Use one each of the screws and stepped screws removed in step 2-1.

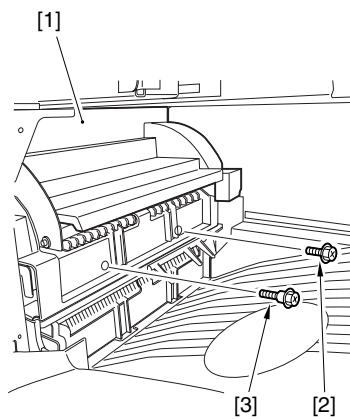

F2-7

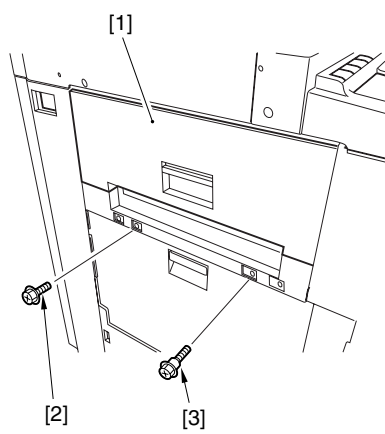

F2-8

- 7) Open the inner 2-way delivery unit, and connect the two connectors [1].

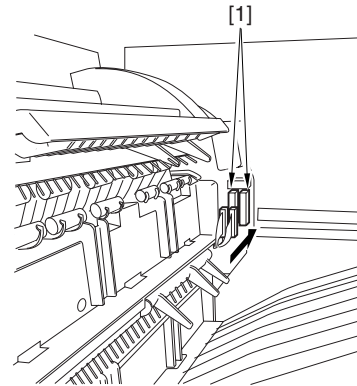

F2-9

- 8) Mount the connector cover [1] with the screw (M4×14) [2] that comes with the tray.

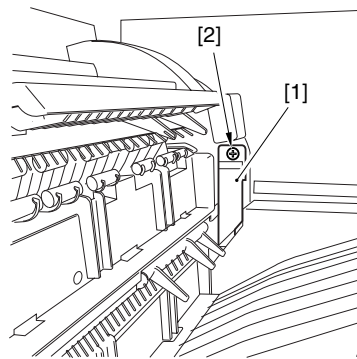

F2-10

- 9) Mount the inside delivery tray [1].

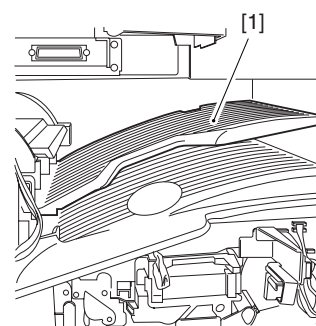

F2-11